

F:\2018\18173.10 - Higher Ground\Child Care Sheets\Onsite\18173.10\HARDSCAPE.dwg Apr 29, 2019 - 5:09pm

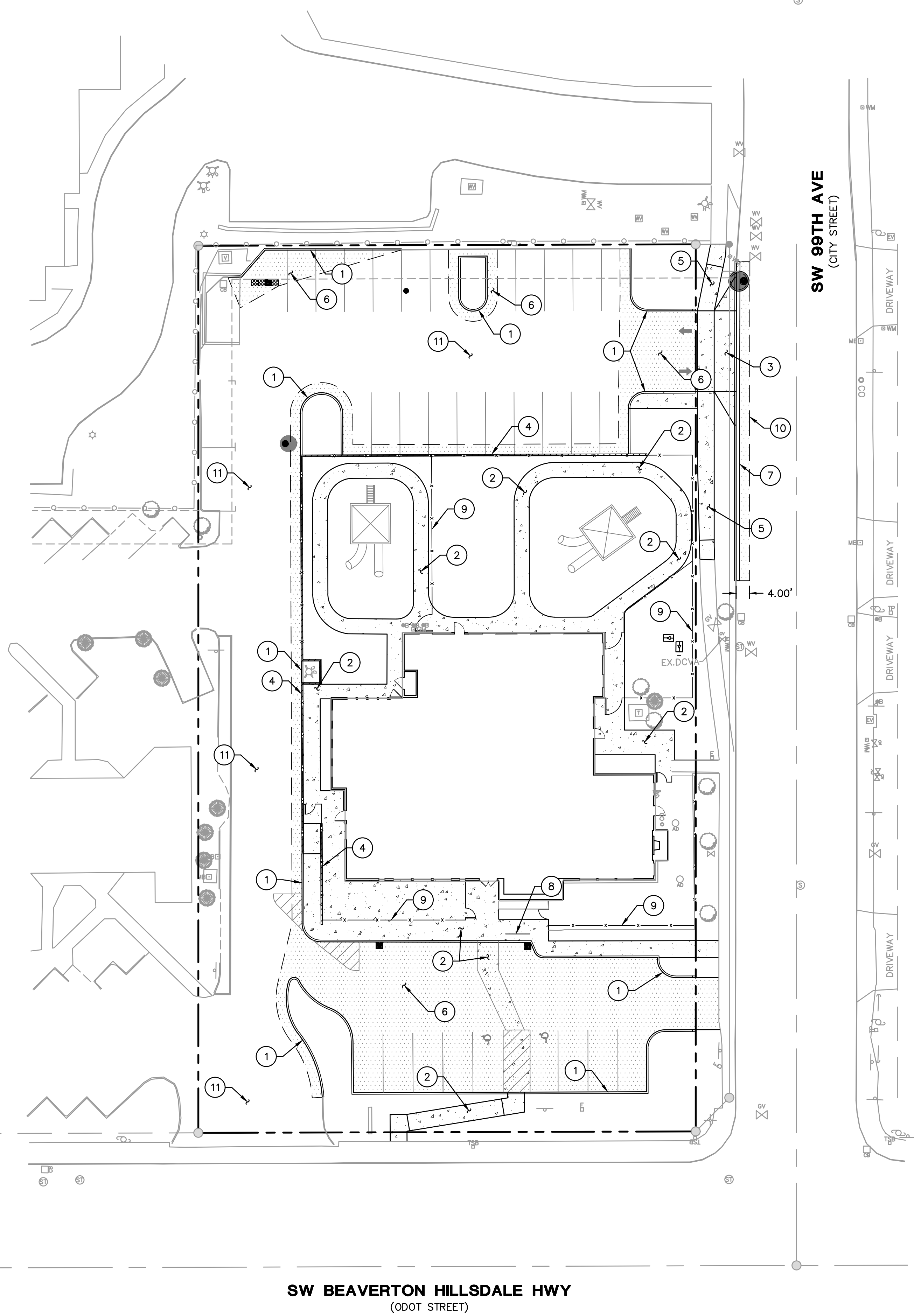

**SHEET NOTES**

1. SEE SHEET C0.1 FOR GENERAL NOTES.
2. SEE ARCHITECTURAL PLANS FOR ADDITIONAL SITE INFORMATION.
3. THE CONTRACTOR SHALL HAVE A FULL SET OF THE CURRENT APPROVED CONSTRUCTION DOCUMENTS INCLUDING ADDENDA ON THE PROJECT SITE AT ALL TIMES.
4. THE CONTRACTOR SHALL KEEP THE ENGINEER AND CITY OF BEAVERTON INFORMED OF CONSTRUCTION PROGRESS TO FACILITATE SITE OBSERVATIONS AT REQUIRED INTERVALS. 24-HOUR NOTICE IS REQUIRED.

**(X) CONSTRUCTION NOTES**

1. INSTALL PRIVATE CURB PER DETAIL 3/C4.0.
2. INSTALL PRIVATE CONCRETE SIDEWALK PER DETAIL 2/C4.0.
3. INSTALL PUBLIC DRIVEWAY PER CITY OF BEAVERTON DETAIL 210/C4.0.
4. NON-STRUCTURAL RETAINING WALL. SEE SHEET C2.0 FOR GRADING INFORMATION. SEE ARCHITECTURAL PLANS FOR DETAILS.
5. INSTALL PUBLIC CONCRETE SIDEWALK PER CITY OF BEAVERTON DETAIL 215/C4.0. SIDEWALK SHALL BE FORMED WITH 1.5% CROSS SLOPE.
6. INSTALL PRIVATE ASPHALT PAVEMENT PER DETAIL 1/C4.0.
7. INSTALL PUBLIC CURB AND GUTTER PER CITY OF BEAVERTON DETAIL 205/C4.2.
8. INSTALL BIKE PARKING. SEE ARCHITECTURAL PLANS FOR MORE INFORMATION.
9. INSTALL SITE FENCING. SEE ARCHITECTURAL PLANS FOR MORE INFORMATION.
10. SAWCUT AND REPLACE EXISTING PUBLIC ASPHALT. SAND SEAL ALL SAWCUT LINES AND PROPOSED CONCRETE EDGES.
11. SEAL COAT ALL EXISTING ASPHALT TO REMAIN AND RESTRIPE. SEE ARCHITECTURAL PLANS FOR ADDITIONAL STRIPING INFORMATION.

**LEGEND**

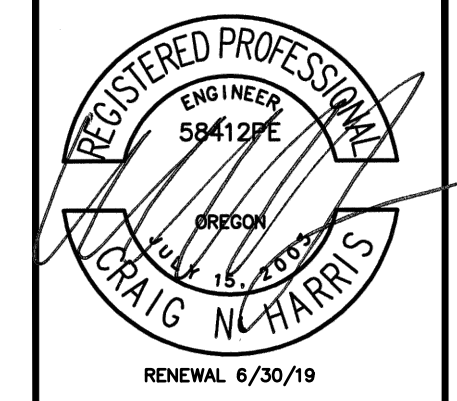
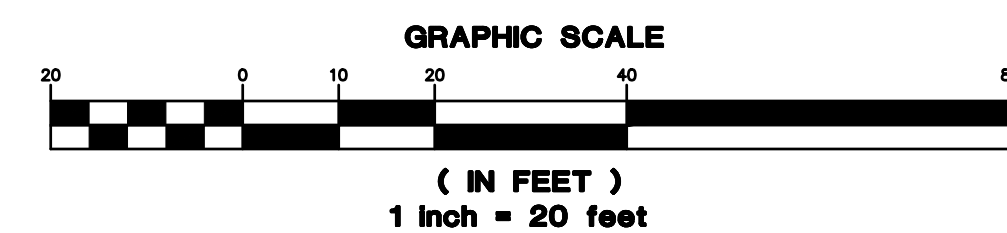
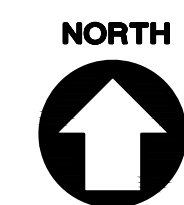

ISSUED DATE	DESCRIPTION
1/23/19	1 SITE DEVELOPMENT PERMIT
2/14/19	2 PERMIT SET
3/8/19	3 PLUMBING COMMENTS
3/21/19	4 ELECTRICAL COMMENTS
4/12/19	5 SITE DEVELOPMENT COMMENTS
	6 PRIVATE SITE PLUMBING PERMIT
	7 SITE DEVELOPMENT RESUBMITTAL

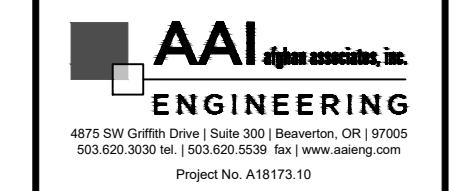

**CIDA** ARCHITECTURE  
ENGINEERING  
PLANNING  
INTERIORS

15895 SW 72ND AVE SUITE 200  
PORTLAND, OREGON 97224  
TEL: 503.226.1285  
FAX: 503.226.1670  
WWW.CIDAINC.COM

TENANT IMPROVEMENT FOR:  
**HIGHER GROUND CHILD CARE**  
4575 SW 99TH AVE.  
BEAVERTON, OR 97005

HARDSCAPE PLAN

**C1.0**

JOB NO. 180192.01  
© 2019 CIDA, P.C./CIDA. ALL RIGHTS RESERVED