

# PHASE 1B

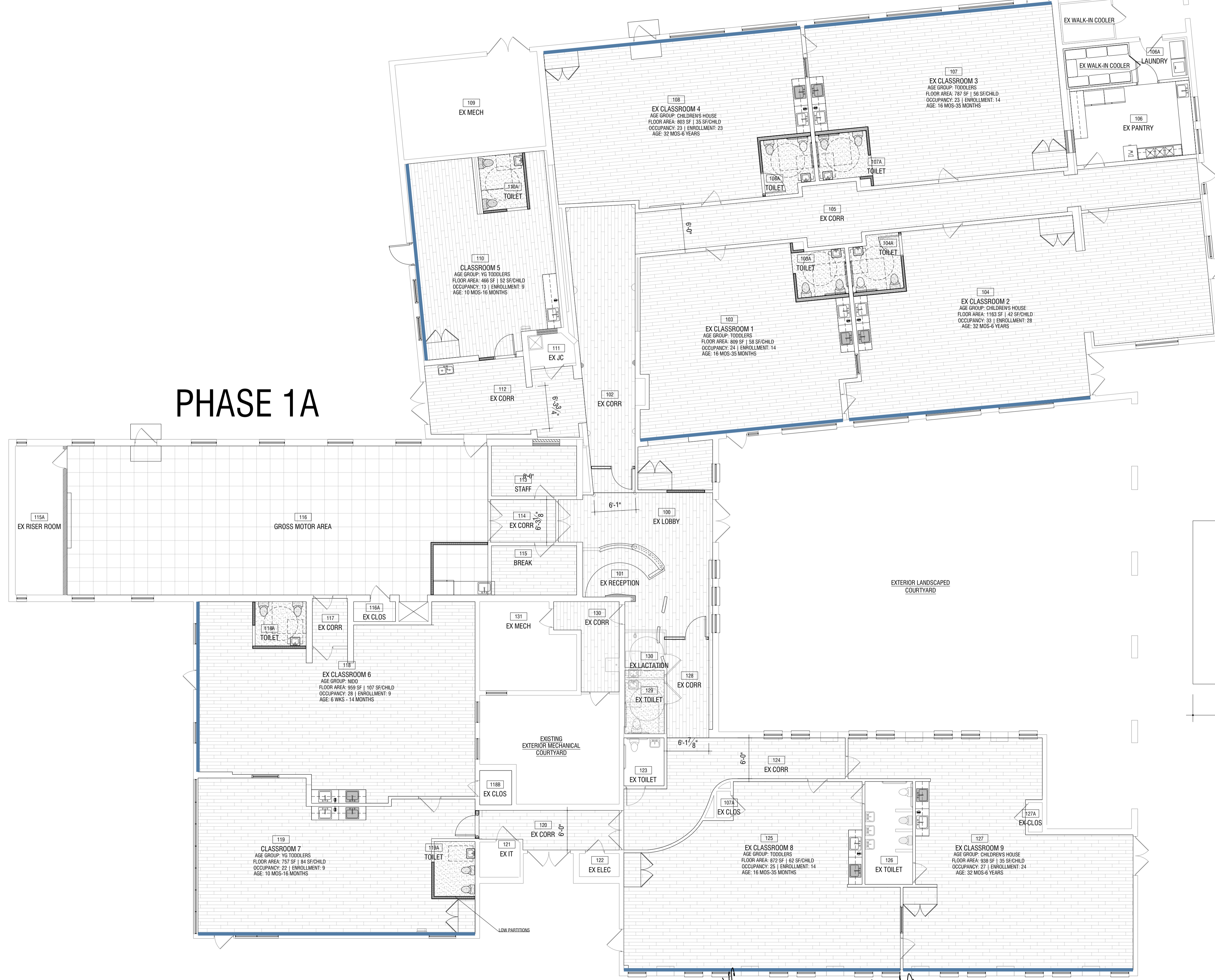

## FINISH SCHEDULE

- NEW LVT FLOORING AND BASE THROUGHOUT ENTIRE INTERIOR.  
 NEW PAINT ON WALLS AND DRYWALL CEILINGS AND SOFFITS THROUGHOUT ENTIRE INTERIOR.
- FLOOR: MOHAWK LVT  
 LIVING LOCAL GLUE DOWN  
 PLANK; SABLE 142
- \* IN ALL TOILET ROOMS, USE SHEET VINYL W/INTEGRAL COVE BASE TO MATCH LVT.  
 ARMSTRONG  
 POSSIBILITIES PETIT POINT  
 88213 WHITE SAND
- GROSS MOTOR AREA: RUBBER FLOORING. HGE TO PROVIDE SPECIFICATION.
- WALLS: TRIM SHERWIN WILLIAMS (SW7005- PURE WHITE) SEMI-GLOSS  
 ACCENT #1 - (50% SW1015 - SKYLINE STEEL) LOW SHEEN EGG SHELL  
 ACCENT #2 - NOT USED  
 ACCENT #3 - (50% SW6442 BRACING BLUE) LOW SHEEN EGG SHELL  
 COMMON AREAS, GENERAL ROOMS, RESTROOMS AND ALL AREAS NOT SPECIFICALLY MENTIONED - (SW7042 - SHOJI WHITE) LOW SHEEN EGG SHELL
- DOORS & FRAMES: SW7042 - SHOJI WHITE - LATEX FINISH
- CEILING: HARD LID/DRYWALL CEILING (SW7005 - PURE WHITE) FLAT
- BASE: BURKE BASIC BROWN  
 RESTROOMS: BASE SHALL BE CONTINUOUS SHEET VINYL COVE BASE
- PROVIDE CONTINUOUS JOHNSONITE LOW PROFILE TRANSITION STRIP WHERE VCT MEETS LVT FLOORING. COLOR TO MATCH LVT.
- ALL FINISHES IN RESTROOMS SHALL COMPLY WITH 2018 IBC 1209.
- INTERIOR FINISHES SHALL HAVE A MINIMUM CLASS "C" INTERIOR FINISH RATING.

SEE KEY NOTE 9 SHEET A301 FOR MORE INFORMATION

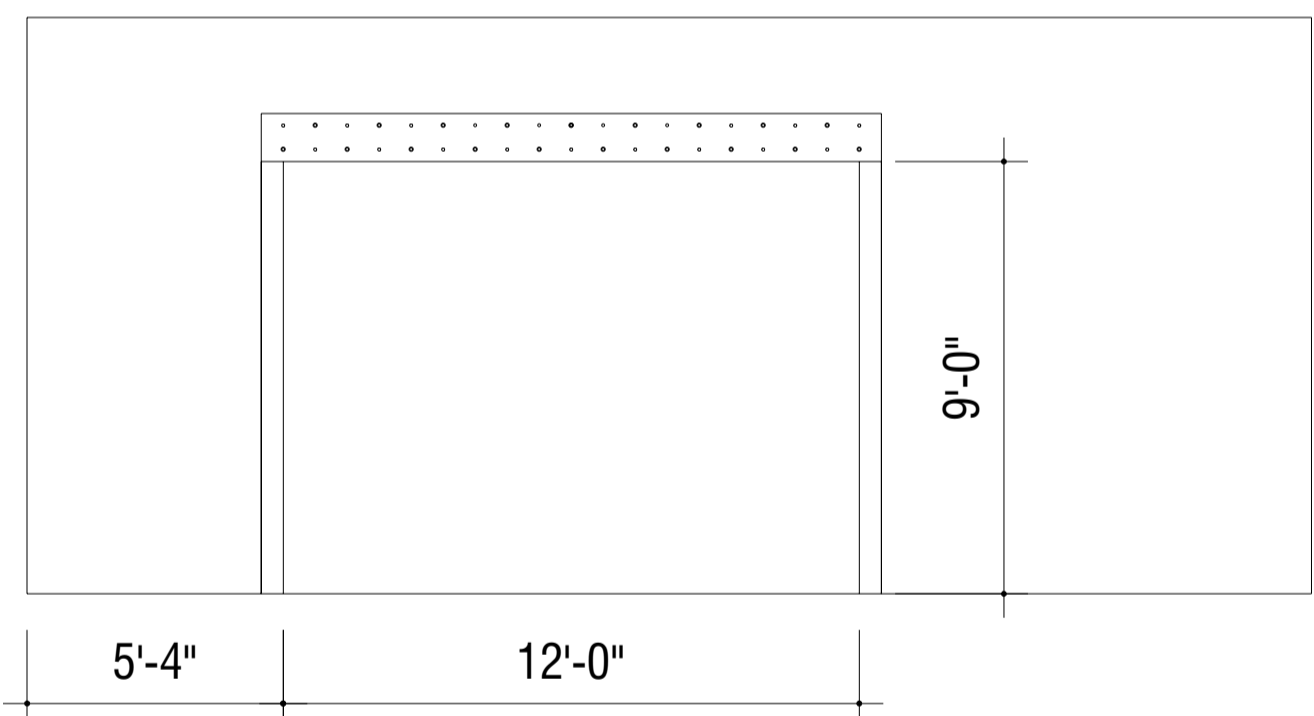

3 FRAMED OPENING DETAIL  
 SCALE: 1/4" = 1'-0"

# PHASE 2

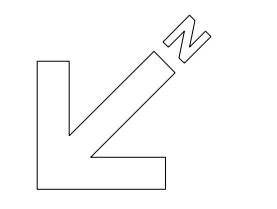

"Professional Certification.  
 I certify that these documents  
 were prepared or approved by  
 me & that I am a duly licensed  
 architect under the laws of the  
 State of Maryland, license  
 number 13664, expiration  
 date 10/22/2023."

guidepost montessori  
 bethesda  
 site ada alteration  
 7108 bradley blvd  
 bethesda . md . 20817



DRAWING NOTES:

MARK	DATE	DESCRIPTION
1	01.24.23	CODE REVIEW RESPONSE

PROJECT #: 21-918  
 FILE NAME: 21-918CD  
 DRAWN BY: HY  
 CHECKED BY: HY  
 SHEET #:

FLOOR FINISH PLAN

A401

FOR CONSTRUCTION